

CW-3000 PROFESSIONAL PROGRAMMABLE MULTISTANDARD CABLE TV HEADEND

USER'S GUIDE

SYSTEM CABINET RACK

CW-3001
CW-3002

12

The 36 module high, 19" wide rack cabinet is flat packed. This guide can help mechanical setting-up but electrical installation needs qualified technician.

The rack cabinet **CW-3001** does not comprise power supply unit, so some parts of the guide do not refer to it.

MECHANICAL ASSEMBLY

After unpacking, remove the door(s) from the frame(s) by twisting the locks in angle of 90 degrees. Then remove the four fixing plates that are used only for transportation.

Lay down one of the frames (1) horizontally on the floor, fix consoles 2, 4, 5 and then the other frame by screws 7, 8, 9 and the hexagon key.

Fix upper cover plate 3 by screws 10, 11.

Set the cabinet upright and adjust the corners if they are not rectangular.

Put the cabinet in the final place and set the side edges to vertical by the adjustable feet.

INSTALLATION

Connect **S1** and **CS1** according to the wiring plan. (**S1** can be found on cover plate 3, and **CS1** at the lower console 5.)

Lead the vertical cables outside the guide-rails and fix them by cable ties to the oval holes of the rails.

Connect the mains plug, switch on the circuit breakers and main switch **S1**. The yellow lamp of the switch should light.

NOTICE: Check whether the light goes out after switching off.

If not, interchange the wires of the main switch. (The red ends should be connected to the middle contacts of the switch).

Check the presence of the mains voltage on the connector down inside the cabinet.

Check the operation of the ventilator at the **MANual** position of switch **S2** on console 2 (up on the back of the cabinet). Set the switch to **AUTO** it will switch on automatically above +40 °C.

By this the installation is completed.

Fix lower cover plate 6 (by the 2 pins at the lower edge and the lock), and replace the doors.

Needless to put doors among the cabinets when set side by side. After the horizontal levelling use fixers (push them in at the open top of the frames).

The package comprises 72 pieces (plus 2 spares) of M5 x 10 screws and plastic flat washers for fixing plug-in units and vented covers.

NOTICE!

Switch **S1** on the upper part of the cabinet is only an operational switch. Use the circuit breakers for switching off the voltage in the cabinet. For total safety, unplug the power cord of the cabinet from the wall socket.

After mounting in the rack cases, make sure not to cascade more than two units for mains (connect one to the lower grounded socket, and connect the second one into the first unit).

The rack cabinet comprises a zero-crossing switch, so heavy transients cannot develop at switching on.

TECHNICAL DATA

Mains voltage	220 V / 50 Hz
Max. power consumption	2000 VA
Electric shock protection	class I.
Mains connection	Dfko 3-102 mains plug with protective ground contact
Protection	IP 20
Standard	MSZ 91-85 (IEC-65)
Mechanical construction	flat packed, 36-module, 19" rack cabinet with 2 side panels, 1 rear panel and class I. mains sockets for the units
Dimensions	566 x 566 x 1870 mm
Mass	approx. 50 kg

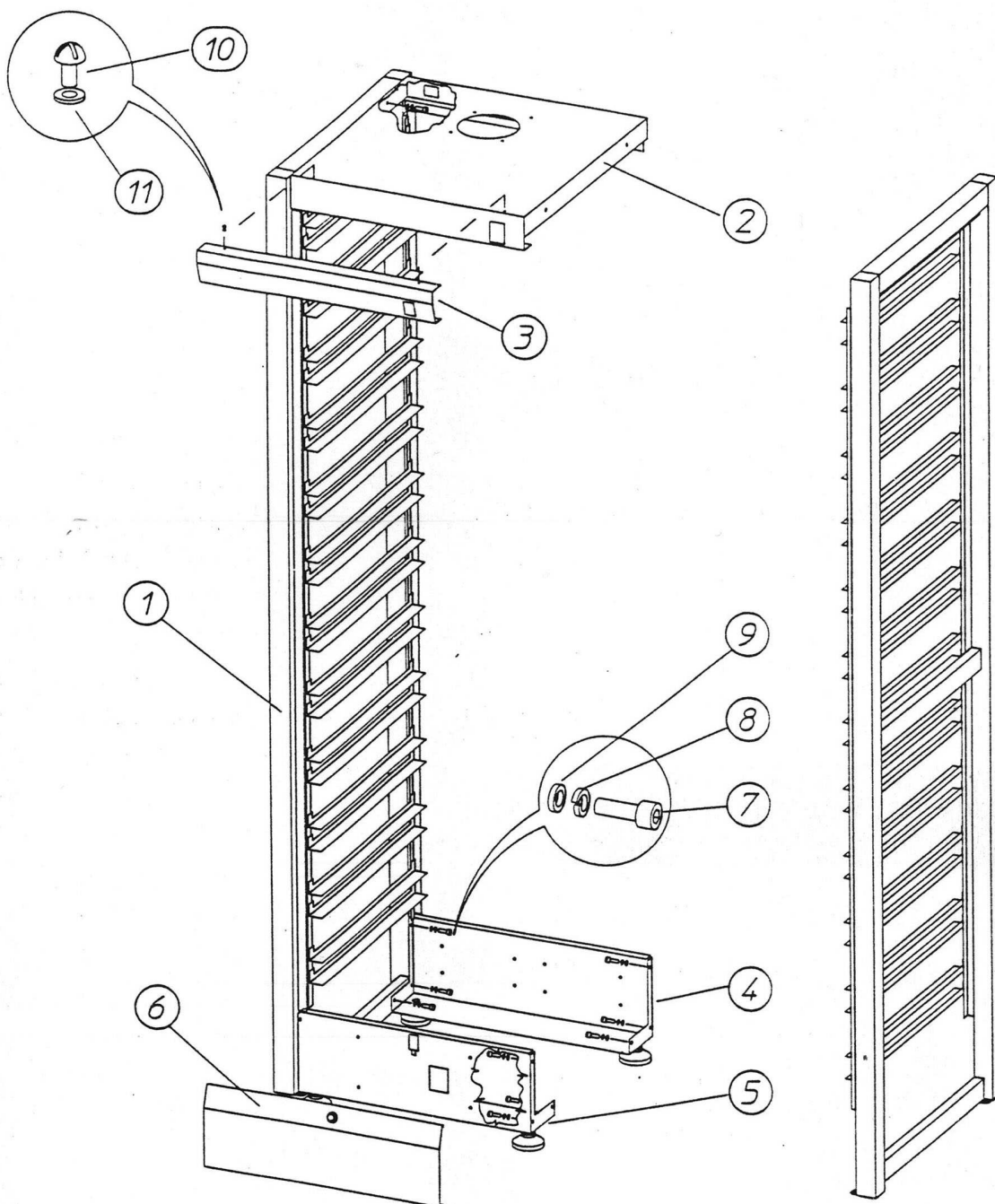

Main parts of the RACK CABINET (see Figure)

1 Mounted frame

2 Upper console

3 Upper cover

4 Mounted rear console

5 Mounted front console

6 Riveted lower cover

7 M6x12 socket screw
(at 16 points)

8 M6 lock washer

9 M6 washer

10 M3 cross pan head screw
(at 2 points)

11 M3 washer

